

**Creative opportunities for high performance cladding designs:
the Design fastener from SFS intec**

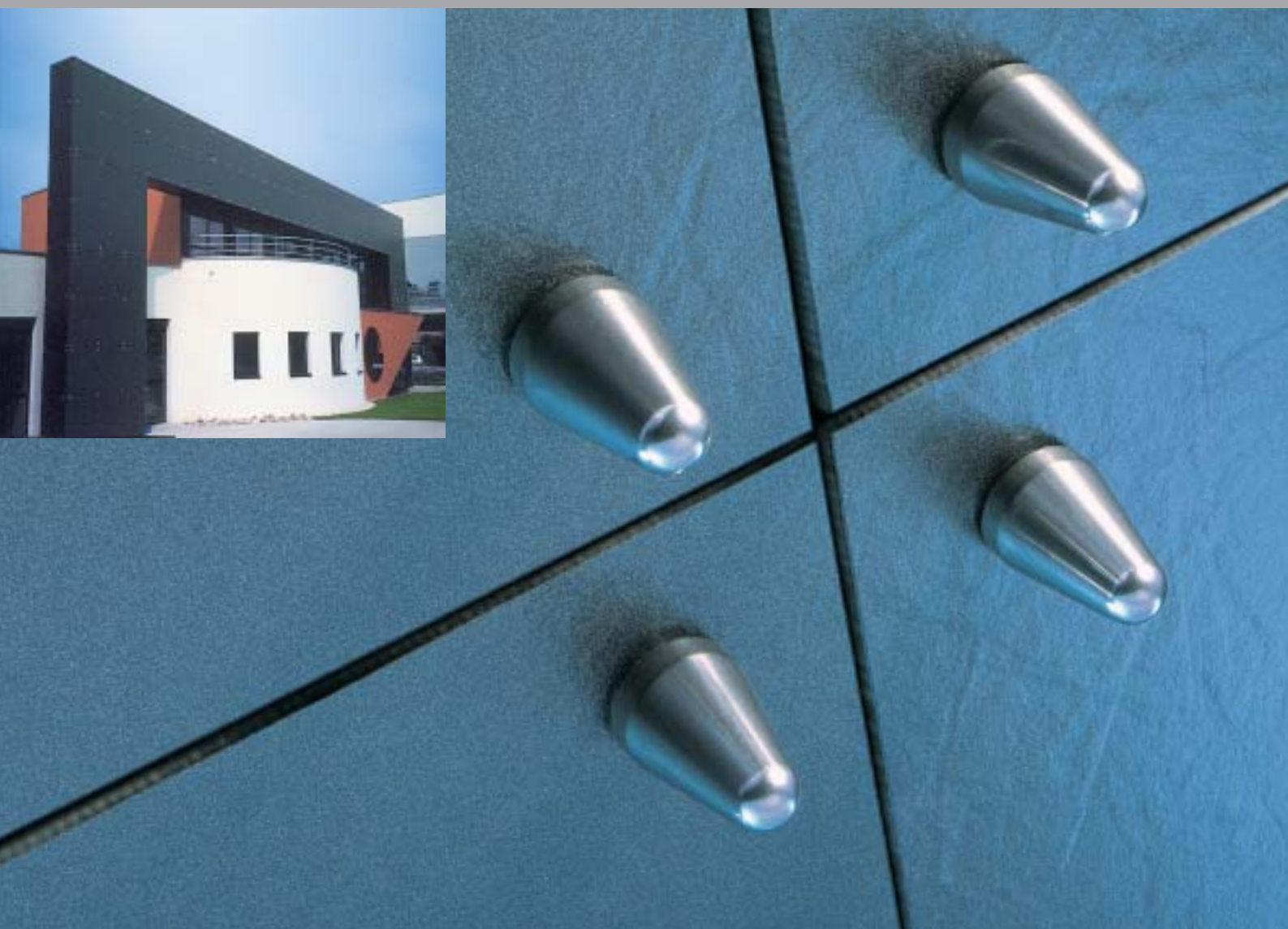

For special aesthetic effects: choose from the Design range from SFS intec

A choice of colours and shapes for fascinating effects

Choose from the range of shapes and colours to create special emphasis on internal or external surfaces. Achieve tonal features through the use of anodised aluminium and polished stainless materials.

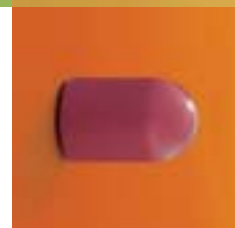

An integrated system

A purpose designed austenitic stainless steel fastener is the basis of this new Design range. It offers secure attachment of high performance cladding to timber, steel or aluminium sub-frames.

The thread onto which the head element is screwed is coated with spedcaps micro-encapsulated liquid adhesive. The adhesive cures within a few hours of installation and the design element is secured against unwinding through dynamic loads. It cannot be removed manually after curing.





Technical information

Order code

GA-AS-S16-6,5x45C

Head Styles

You can choose from six designs, two different materials and in the case of aluminium six Eloxal colours.

Head styles are available in stainless steel with a natural finish and in aluminium which are anodised in one of six colours.

The Design head can be assembled effortlessly by hand onto the installed fastener. But cannot be unscrewed after curing.

Order code:
GAZ-807-A-gold or
GAZ-811-S

Setting tools

- SFS E395 socket
- Drive bar ZA 1/4"
- DI600 electric screwgun or
- DI412 battery-powered screwgun

If you need further information or have any questions regarding a specific project please call our technical help-line.

Fastening to thin steel or aluminium purlins

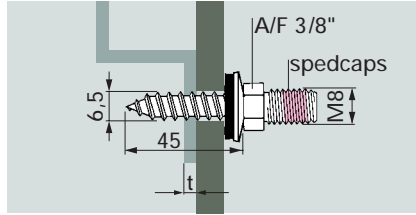

t steel min. 1,0 – 1,5 mm pilot hole Ø 4,5 mm
1,6 – 3,0 mm 5,05 mm

t aluminium min. 3,0 mm pilot hole Ø 4,8 mm

Fastening to timber battens

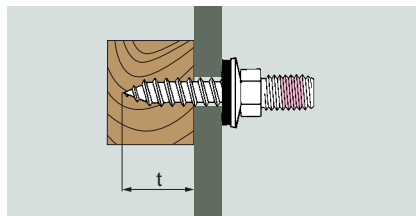

t min. 38 mm pilot hole Ø 4,8 mm

GA-BS-S16-6,3x32C

Fastening to steel purlins

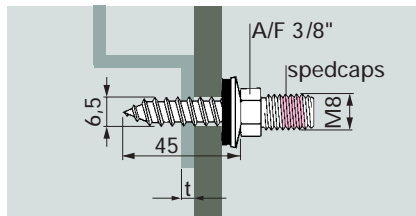

t steel min. 2,0 – 4,0 mm pilot hole Ø 5,35 mm
4,1 – 6,0 mm 5,65 mm
> 6,0 mm 5,8 mm

Cladding panels

For clearance holes in cladding panels, please check the cladding manufacturers literature.

Order code

Type	Shape	Material	Colour
GAZ -	807 -	A -	gold

801

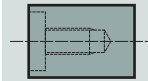

Ø 22 × 32 mm

803

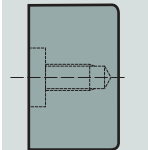

Ø 42 × 28 mm

804

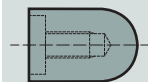

Ø 22 × 32 mm

806

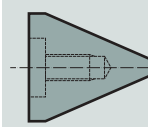

Ø 32 × 38 mm

807

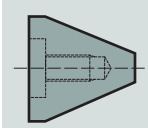

Ø 32 × 32 mm

811

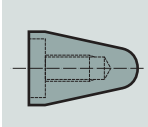

Ø 22 × 32 mm

A
anodised
aluminium

red



gold



green



black



blue



silver

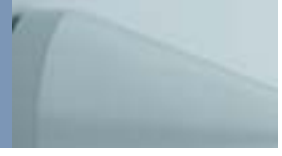

S - mill finish

S
stainless
steel

mill finish

