

**Fixing timber cladding to steel and  
timber frames.  
The Mini WT and SCS systems**

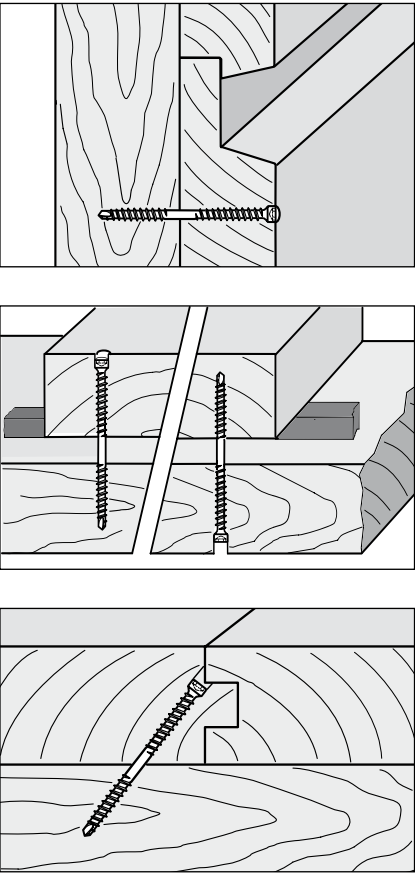

# External timber-to-timber fixing

## The Mini WT self-tapping wood screw



**The advantages at a glance:**  
 Using the smaller diameter WT fasteners (4.5 mm, 5.0 and 6.5 mm dia.) offers enormous advantages in fitting all wooden boarding, decking and cladding:

- Achievable aesthetic solutions, because fixing points are barely visible
- Reduced tendency to splitting, thanks to the smaller heads
- Smaller, easily sunken heads prevents water penetration
- Minimal or zero colouration of the timber thanks to the Durocoat corrosion proofing or A2 stainless steel material
- Secure fixing and retention even during timber expansion and contraction, thanks to the double thread
- High push and pull over-torque values
- Whether angled, flush or countersunk, fasteners can be fixed securely
- Smooth, clean installation – even into larch
- Stainless steel version S for applications in treated timber and corrosive environments

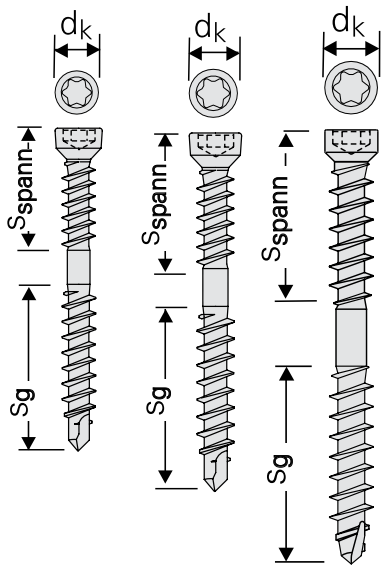

WT-T-4,5xL    WT-S-5,0xL    WT-T-6,5xL

Product range								
Type	Material	belted	Thread Ø [mm]	Length [mm]	S <sub>g</sub> [mm]	S <sub>spann</sub> [mm]	d <sub>k</sub> [mm]	Bit
WT -	<b>S</b>	–	5,0 x	45	23	17	7,0	T20
WT -	<b>S</b>	–	5,0 x	60	23	17	7,0	T20
WT -	<b>S</b>	– M –	5,0 x	45	23	17	7,0	T20
WT -	<b>S</b>	– M –	5,0 x	60	23	17	7,0	T20
WT -	<b>S</b>	–	6,5 x	65	28	28	8,0	T30
WT -	<b>S</b>	–	6,5 x	90	40	40	8,0	T30
WT -	<b>S</b>	–	6,5 x	130	55	55	8,0	T30
WT -	<b>T</b>	–	4,5 x	40	20	15	6,5	T20
WT -	<b>T</b>	–	4,5 x	60	23	17	6,5	T20
WT -	<b>T</b>	– M –	4,5 x	40	20	15	6,5	T20
WT -	<b>T</b>	– M –	4,5 x	60	23	17	6,5	T20
WT -	<b>T</b>	–	6,5 x	65	28	28	8,0	T30
WT -	<b>T</b>	–	6,5 x	90	40	40	8,0	T30
WT -	<b>T</b>	–	6,5 x	130	40	40	8,0	T30

Material: **S** = stainless steel A2  
 T = Carbon steel with Durocoat protection

Accessories	
Bit WT-T-4,5 x L and WT-S-5,0 x L <b>WT-T20</b> WT-T-6,5 x L <b>WT-T30</b>	Depth locator <b>Z661 WT</b> suitable to DI 600 

## External timber-to-metal profile assembly

### SCS twin-wing fasteners for fixing timber to steel and aluminium frames

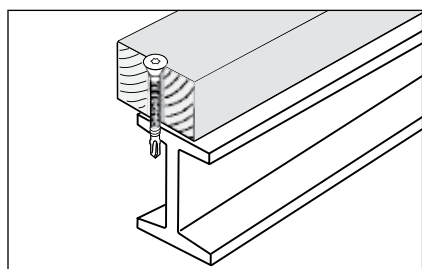
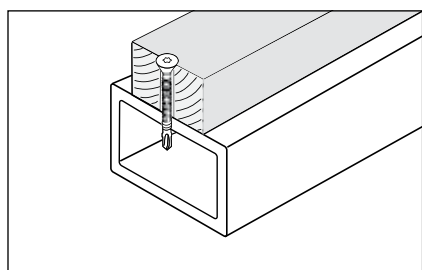
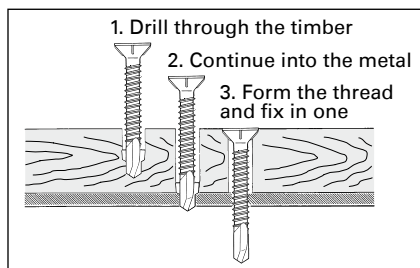

#### The SCS system strengths at a glance:

- Fixing timber to steel frameworks in one step
- Guaranteed pre-drill diameter ensures optimum fixing strength in the sub-frame
- Matched installation tools enable fast, ergonomic assembly work
- Countersunk heads enable efficient anchorage in both hard- and softwoods
- Strong corrosion resistance of A2 stainless steel material
- Toughened, zinc-plated insertion tips
- Increased diameter of the timber drilling means reduced problems through later timber shrinkage and expansion
- No discolouration of the timber thanks to A2 stainless
- Optimum contact pressure

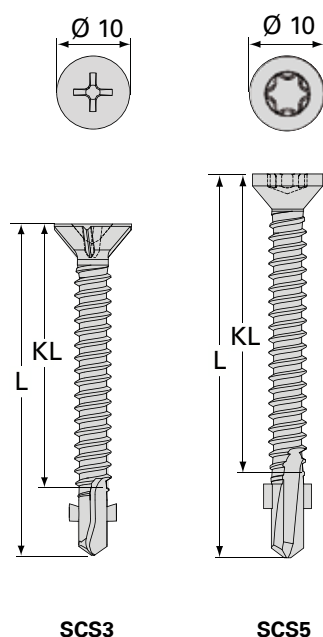

Product range							
Type	Drilling capacity steel*/alu [mm]		Clamping length <b>KL</b> [mm]		Thread Ø [mm]	Length <b>L</b> [mm]	Bit
<b>SCS</b>	3	/	27	-	4,8x	42	PH2
<b>SCS</b>	3	/	57	-	4,8x	72	PH2
<b>SCS</b>	5	/	34	-	5,5x	55	T30
<b>SCS</b>	5	/	54	-	5,5x	75	T30

Material: **S** = stainless steel A2

**KL**: Thickness of total package (wood and metal)

\* Steel S235 / St 37

Accessories	
Bit <b>PH2</b> - Lg 90 mm	Depth locator <b>Z661 WT</b> suitable to DI 600
<b>T30</b> - Lg 90 mm	



## Installing tools



### DI 600

For Mini WT and SCS fasteners  
Nominal power rating : 600 W  
Voltage : 230 V  
Rev. count : 0 - 2000 rpm  
Torque rating : 1900 Ncm  
Weight : 1,6 kg



### CF40 - 12 R

For SCS fasteners  
Nominal power rating : 500 W  
Voltage : 230 V  
Rev. count : 0 - 2100 rpm  
Weight : 4,1 kg



### Holz Her 3338 (not in the standard range)

Driver type belts for Mini WT  
Fastener:  
WT-T-M-4,5xL  
WT-S-M-5xL



### Separator profile (not in the standard range)

External timber cladding is always subject to deformation. This varies according to the timber used, treatments and weather conditions. Depending on the form and geometry of the joints used, it can lead to quite pronounced forces being exerted on the structure. For this reason, we recommend separating timber cladding from the framework with a buffer to allow for movement. A thick EPDM tape - minimum 10 mm x 10 mm - can be used for this purpose. This also improves timber protection.

### Application

To facilitate safe and easy installation of Mini WT and SCS self-tapping fasteners, we recommend the automatic equipment shown. The depth setting gauge enables smooth, efficient, set-depth insertion every time – at maximum operating speed. The CF 40-12 R tool improves fastener guidance and further increases operator comfort and performance.

## SFS intec – A philosophy centred on quality



SFS intec achieves a high standard of quality in both products and support services via a fully integrated quality management system. SPC control throughout the entire manufacturing process is at the heart of the invariable product quality from SFS intec.

## eServices – An indispensable tool for your day-to-day work



Constant information exchange with our customers is essential to support the continuous development of our products and services. On our homepage under "e-services" you will find catalogues, documentation, technical data, product drawings and a variety of services on offer.

## More information

If you have questions on any aspect of fasteners and fixings, just contact us. We are only too pleased to help!

SFS intec AG / FasteningSystems / CH-9435 Heerbrugg / fs.heerbrugg@sfsintec.biz / www.sfsintec.biz

**SFS** intec  
Turn ideas into reality.